



GROW-WITH-ME PONY MANUAL

⚠ WARNING

- **PARENTS: MONITOR YOUR CHILD'S PLAY ACTIVITY TO ENSURE PROPER AND SAFE USE OF THIS PRODUCT.**
- **REMOVE ALL PACKAGING, CLIPS, STAPLES, TIES AND SIMILAR ATTACHMENTS BEFORE GIVING THIS TOY TO A CHILD, AS THESE ATTACHMENTS POSE A POTENTIAL CHOKING HAZARD AND ARE NOT PART OF THE TOY.**
- **ADULT ASSEMBLY IS REQUIRED.**
- **PARENTAL SUPERVISION IS REQUIRED.**
- This product is designed for a child at least 9 months old and weight not exceeding 50 lbs (22.7 kgs).
- Allow only one child on the product at a time.
- Never allow the child to play with the product near roadways, streets, swimming pools, hills, sloped driveways, ramps, steep inclines, or stairs. Use only on a level surface.
- Always wear shoes while riding.
- Do not allow another child to push the product when a child is sitting on it.
- Do not allow the child to stand on the product.
- The child should always sit in the forward facing position.
- The child's feet should remain in the stirrups at all times while riding the toy.
- Inspect toy periodically for loose or damaged components.

PARTS AND TOOLS LIST

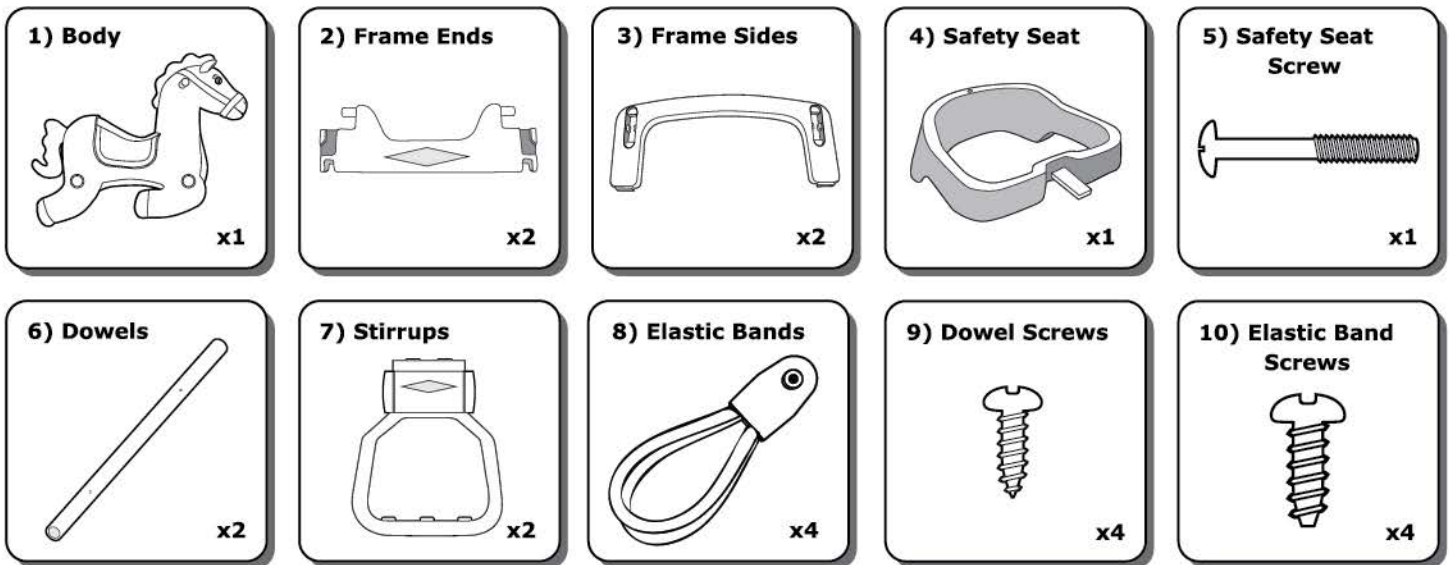

Tools Required for Assembly (not included)

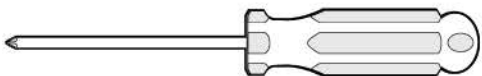

⚠ WARNING :

ADULT SUPERVISION REQUIRED.

THIS PACKAGE CONTAINS SMALL PARTS WHICH HAVE HAZARDOUS SHARP POINTS IN THE UNASSEMBLED STATE. FOR ADULT ASSEMBLY ONLY. CARE SHOULD BE TAKEN IN THE UNPACKING AND ASSEMBLY OF THIS TOY.

⚠ WARNING :

ANY RUBBER BANDS, PLASTIC SECURING BANDS, WIRE TIES AND TAGS, USED IN THIS PACKAGING ARE NOT PART OF THIS PRODUCT AND SHOULD BE REMOVED FOR YOUR CHILD'S SAFETY. ANY CONTACT WITH MOISTURE OR LIQUID WILL DAMAGE THE ELECTRONICS. COLORS AND DECORATIONS MAY VARY.

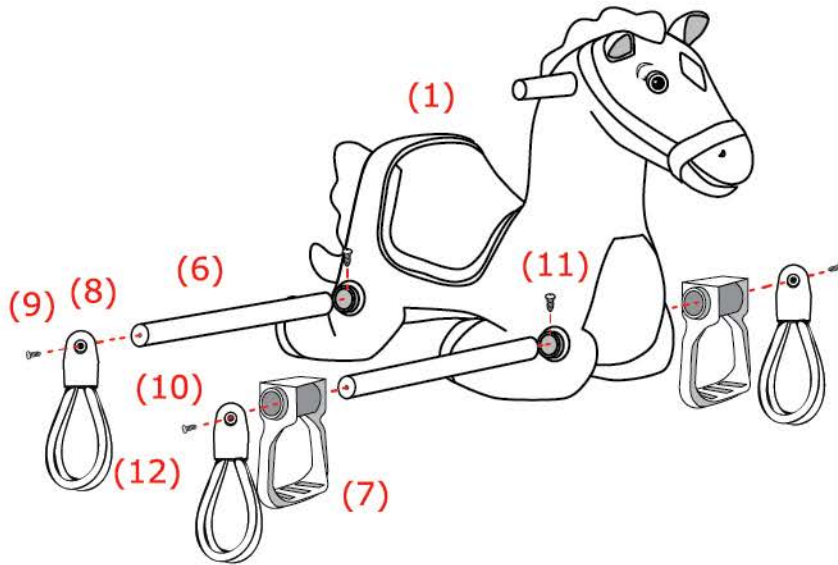
1**Step 1:**

Insert the two dowels (6) into the holes on the pony's (1) side, lining up the holes on the dowels with the holes on the pony. Screw in all four dowel screws (9).

Starting with the front dowel add the stirrup (7), then the elastic band (8). Secure in place using elastic band screws (10). Repeat for other side of dowel.

On the rear dowel (6) place the elastic band (8) on the end and secure in place using elastic band screw (10). Repeat for other side.

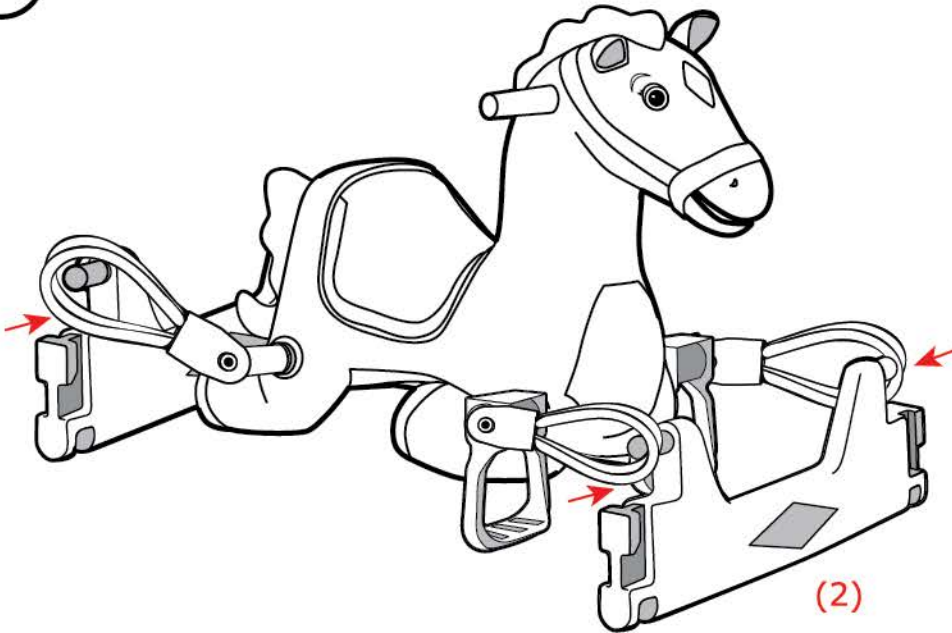
2**Step 2:**

Slip the elastic band (8) over the pegs on the frame ends (2). Repeat for all four elastic bands.

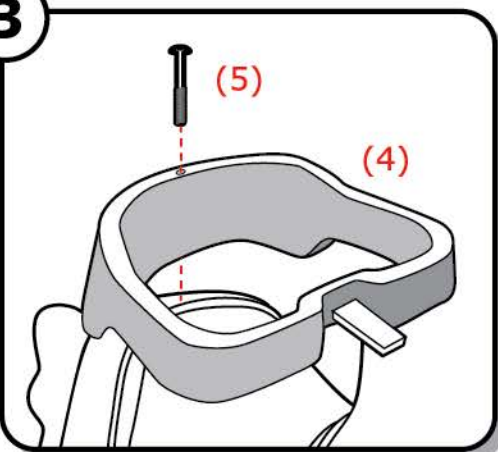
3**Step 3:**

To attach the safety seat (4), insert the front piece into the back of the pony's (1) neck and secure with the safety seat screw (5).

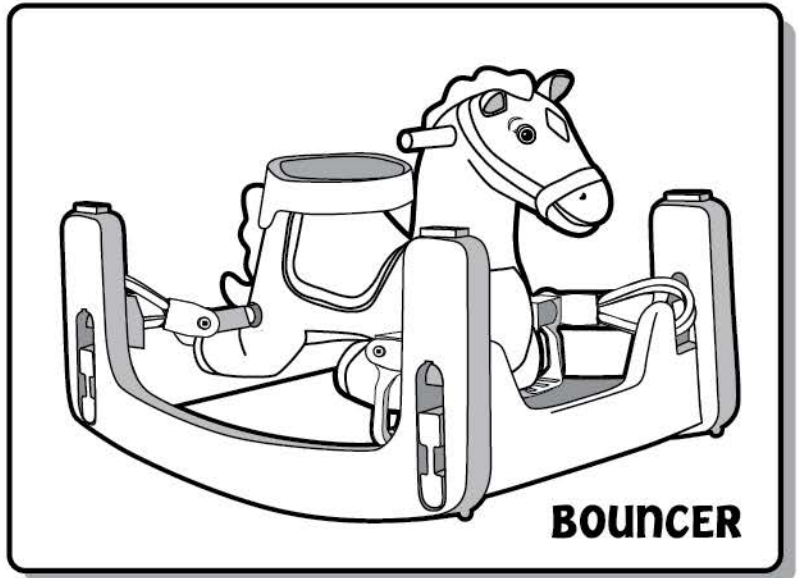
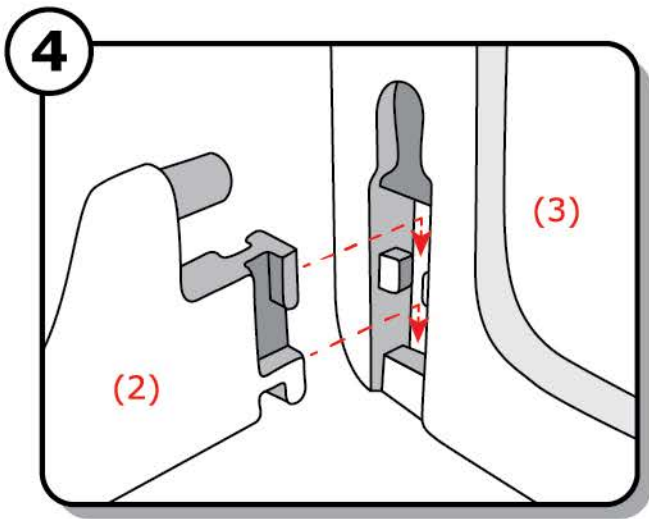

Step 4:

To create the bouncer and rocker base, have the frame side (3) legs faced up with the smooth side facing outward. Connect the frame ends (2) to the frame sides (3) by sliding in and then going down until you hear a "click" sound. Repeat on opposite end.

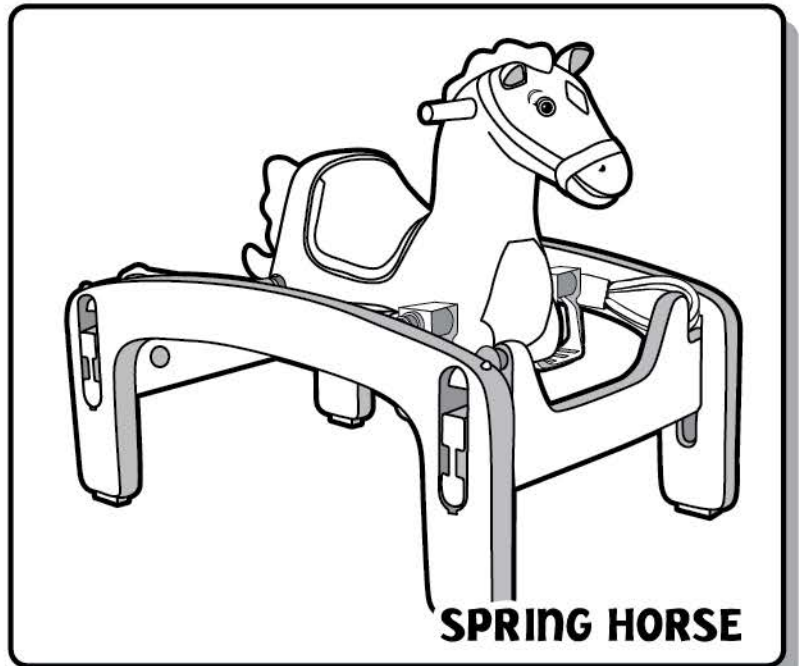
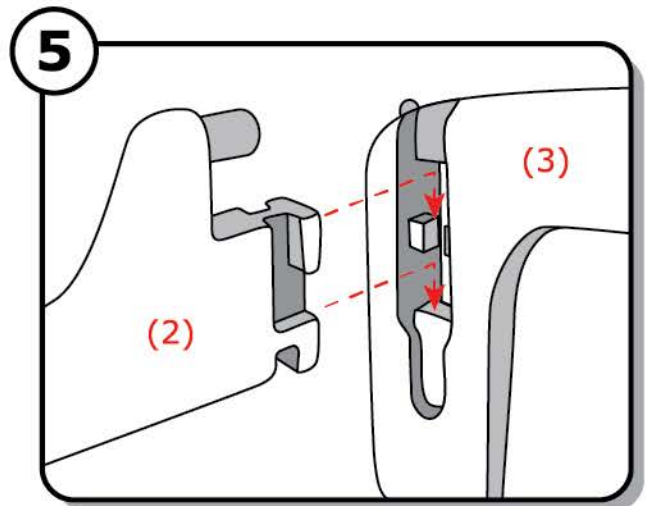
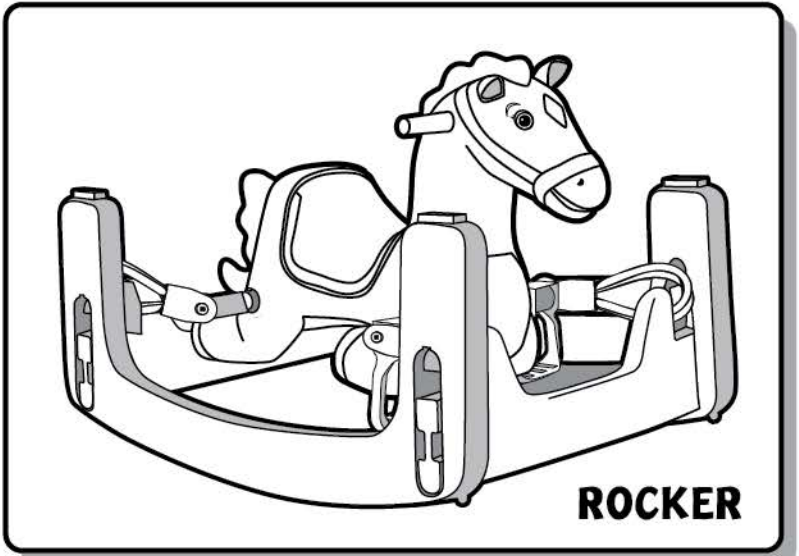

Step 5:

To create the spring horse base, have the frame side (3) legs faced down with the smooth side facing outward. Connect the frame ends (2) to the frame sides (3) by sliding in and then going down until you hear a "click" sound. Repeat on opposite end.

ELECTRONIC FEATURES

Please note: For best performance of electronic features, we recommend replacing the batteries that came with this product with brand new alkaline batteries.



SOUND EFFECTS AND MOVING MOUTH

The sound effects and moving mouth features are activated by squeezing either of the horse's ears. If the sound becomes distorted or the mouth stops working please replace the batteries as outlined in the Battery Replacement section of this manual.

MOTION-ACTIVATED GALLOPING

The motion activated galloping sensor is located in the horse's head and will make galloping sounds when a child bounces on the horse. This feature is disabled when the horse is in TRY ME mode. TRY ME mode is controlled by the switch located on the battery compartment. Please see the Battery Replacement section of this manual for the location of the battery compartment.

VOLUME CONTROL

You can adjust the sound effect volume by sliding the switch on the battery compartment to either low  or high . Please see the Battery Replacement section of this manual for the location of the battery compartment.

BATTERY REPLACEMENT

The battery compartment is located under a Velcro strip on the left side of the horse's mane. You will need a small Phillips screwdriver to open the compartment. When you are finished replacing the batteries, securely fasten battery cover and screw, stick the battery box back into the pouch, and re-seal the Velcro strip.

⚠ WARNING

- 1) Only an adult should replace batteries.
- 2) Remove exhausted batteries and dispose of properly.
- 3) This toy uses 3 AA batteries.
- 4) Install batteries correctly observing the polarity (+,-) signs.
- 5) We recommend use of alkaline batteries for optimal performance of electronic features.
- 6) Do not mix old and new batteries.
- 7) Do not mix alkaline, standard (Carbon-Zinc), and rechargeable (Ni-Cad) batteries. Only batteries of the same or equivalent type as recommended are to be used.
- 8) Remove the batteries if the toy will not be in use for an extended period of time.

CARE AND MAINTENANCE

- Check all nuts and screws prior to use and periodically thereafter. Tighten or replace as necessary.
- Product may be cleaned with a mild household detergent and warm water.
- Scratches on metal parts may be touched up with a non-lead based paint.
- Do not place near stairways, wall heaters, fireplace or any source of extreme heat.
- Check all plastic and metal parts for cracks, cuts and/or excessive wear. Replace as necessary.
- Any contact with moisture or liquid may damage the electronics.
- Occasionally check to see that all screws are tight and secure.
- If the sound is not operating correctly, replace the batteries.
- Make sure all hardware is tightened and securely in place before the child rides the toy.
- Please note: all elastic bands, stirrups, and screws are contained inside the small box within the package for shipping purposes.

This product conforms to ASTM-F963. Standard Consumer Safety Specifications on Toy Safety. This instruction manual contains assembly instructions, safety and maintenance tips.

PLEASE KEEP THIS MANUAL FOR FUTURE REFERENCE

Tek Nek Toys International, Inc.
Colleyville, TX 76034 USA
customerservice@teknectoys.com

Made in Dongguan, China.
Pat. No. US 6,524,156/6,780,076
www.myrockinrider.com

⚠ WARNING

WHEN CHANGING THE BATTERIES, THE SCREW THAT SECURES THE BATTERY COMPARTMENT SHOULD BE KEPT AWAY FROM CHILDREN AS IT POSES A POTENTIAL CHOKING OR INHALATION HAZARD.